

# DRANESVILLE ELEMENTARY SCHOOL COMMUNITY MEETING



**AUGUST 20, 2024**

# Team Introduction

- FCPS Design and Construction
  - Jordan Short – Senior Manager
  - Billy Lariscy – Construction Manager
  - Patrick Meier – Site Supervisor
- Consultant Design Team
  - MTFA Architecture – Architect
  - Adtek Engineers – Civil Engineer
  - Linton Engineering – Structural Engineer
  - 2rw Consultants – MEP Engineer



# Project Timeline

- ❖ CIP – Planning and Design Funded
  - ❖ 2021 School Bond – Planning/Design
- ❖ Permitting 2023-2024
- ❖ Construction (2 years) Summer 2024
- ❖ Completion Winter 2026

# Project Scope

- FCPS Educational Specifications
  - Current Enrollment: 588 students
  - Proposed Design Capacity: 1000 students
- Additions
  - Cafeteria and Main Corridor Expansion
  - New Classrooms
- Renovations
  - Administrative Suite Relocation w/ Security Vestibule
  - Reconfigured and Renewed Classrooms and Support
  - New Library
  - Renovated and Enlarged Gymnasium
  - New Electrical, Mechanical and Plumbing Systems
  - New Windows, Doors, Finishes
- Occupied Phased Construction



# Existing Aerial View



**PARKING SPACES: 80**

**BUSES: 11**

**SITE AREA: 13.15 ACRES (572,814 SF)**

**ZONING: R-3**

**EXISTING BUILDING AREA: 88,116 SF**

POWELLS TAVERN PLACE

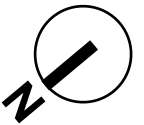



# Proposed Site Plan

**PARKING SPACES: 135**

**BUSES: 14**

**SITE AREA: 13.15 ACRES (572,814 SF)**

**ZONING: R-3**

**PROPOSED ADDITION AREA: 43,318 SF**

**PROPOSED OVERALL BUILDING AREA: 117,361 SF**

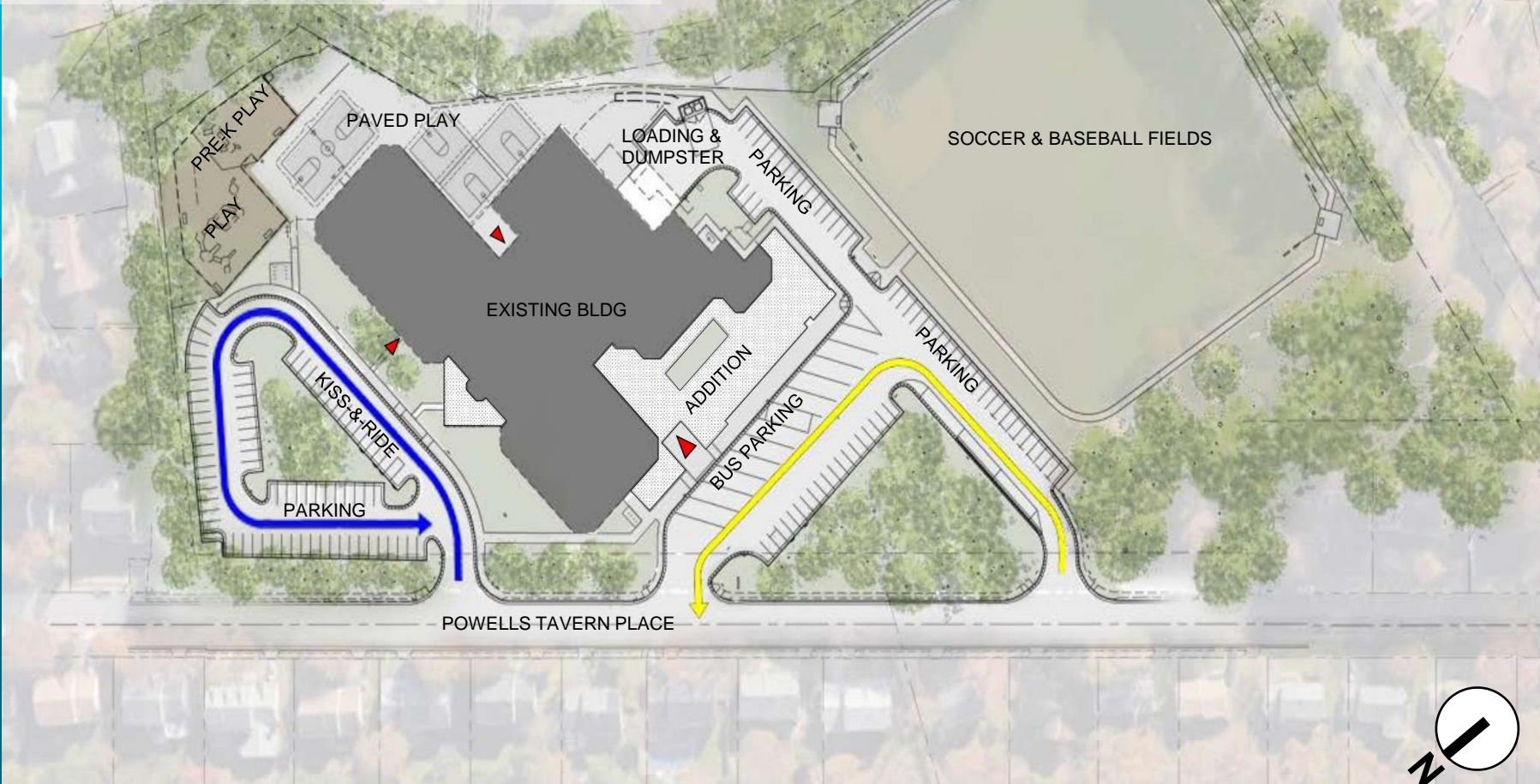
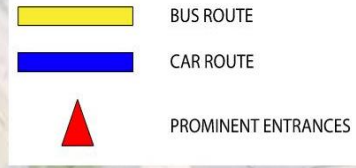

# Existing Floor Plan

## First |

### LEGEND

- GENERAL LEARNING AREA
- GYMNASIUM, MUSIC, ART
- SPECIAL EDUCATION & INSTRUCTIONAL
- ADMIN & HEALTH
- CAFETERIA, FOOD SERVICE, SACC
- INSTRUCTIONAL LIBRARY
- OVERALL BUILDING SUPPORT
- CIRCULATION

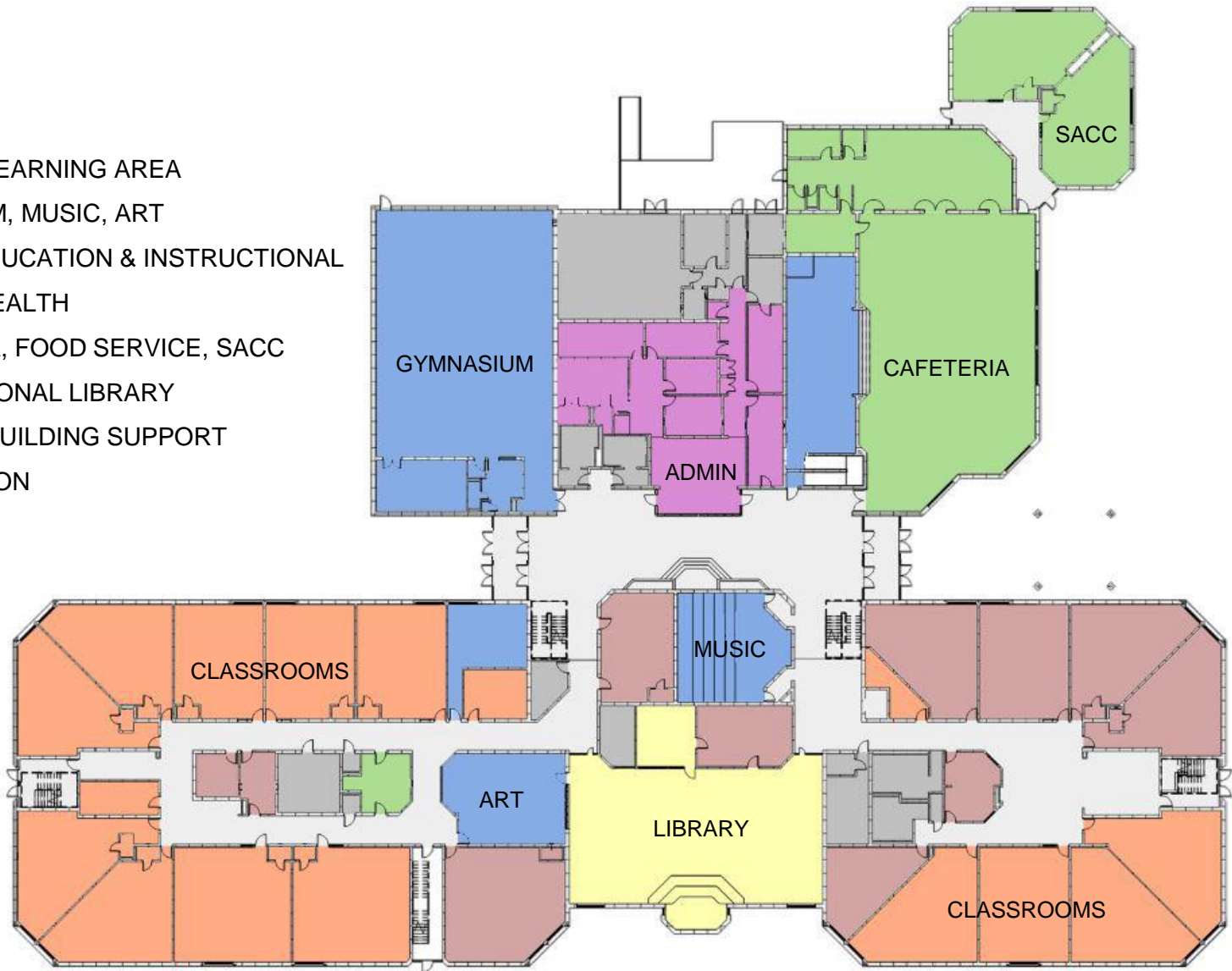

# Existing Floor Plan

## Second Floor

### LEGEND

- GENERAL LEARNING AREA
- GYMNASIUM, MUSIC, ART
- SPECIAL EDUCATION & INSTRUCTIONAL
- ADMIN & HEALTH
- CAFETERIA, FOOD SERVICE, SACC
- INSTRUCTIONAL LIBRARY
- OVERALL BUILDING SUPPORT
- CIRCULATION

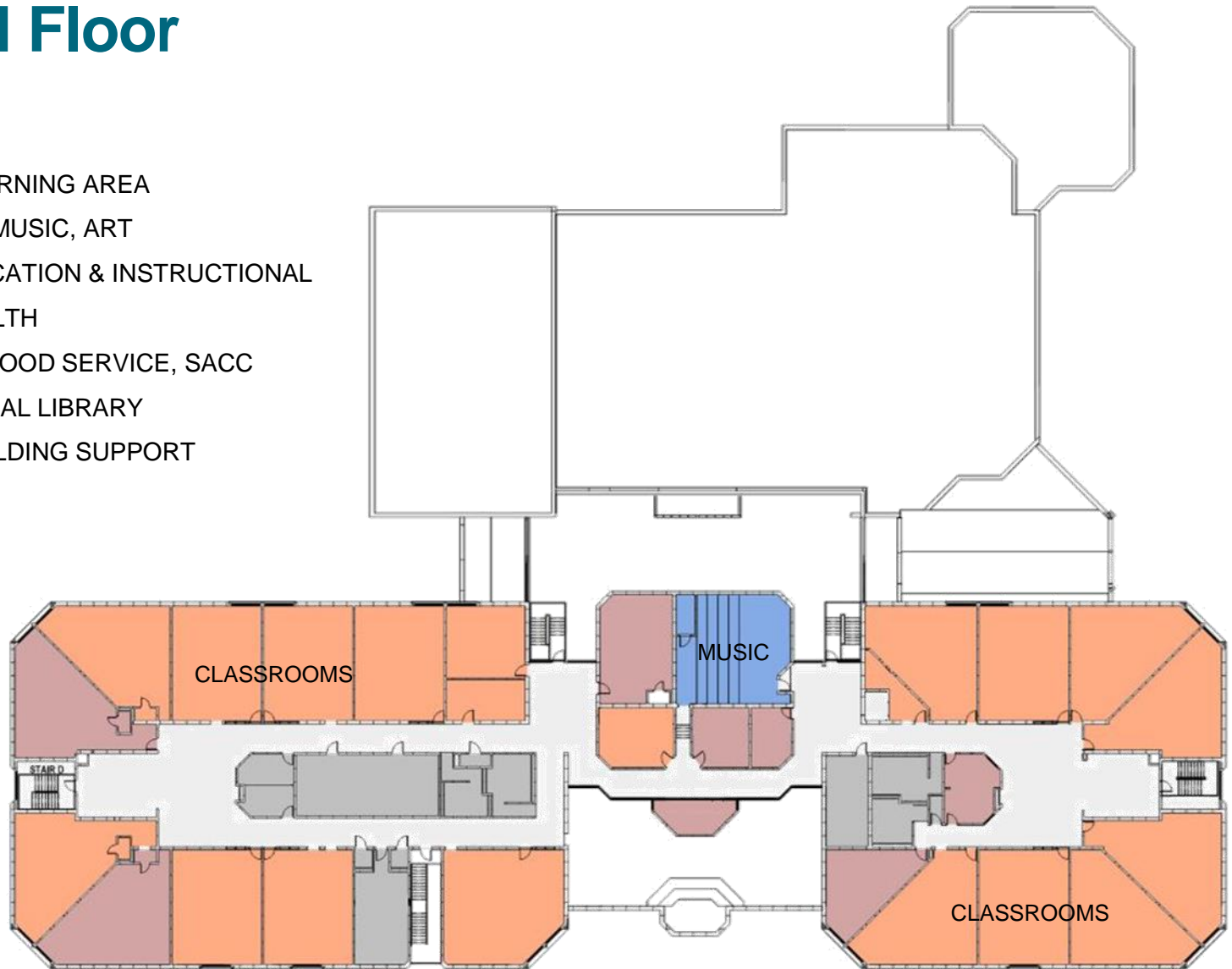



# Proposed Floor Plan

## First Floor

### LEGEND

- GENERAL LEARNING AREA
- GYMNASIUM, MUSIC, ART
- SPECIAL EDUCATION & INSTRUCTIONAL
- ADMIN & HEALTH
- CAFETERIA, FOOD SERVICE, SACC
- INSTRUCTIONAL LIBRARY
- OVERALL BUILDING SUPPORT
- CIRCULATION

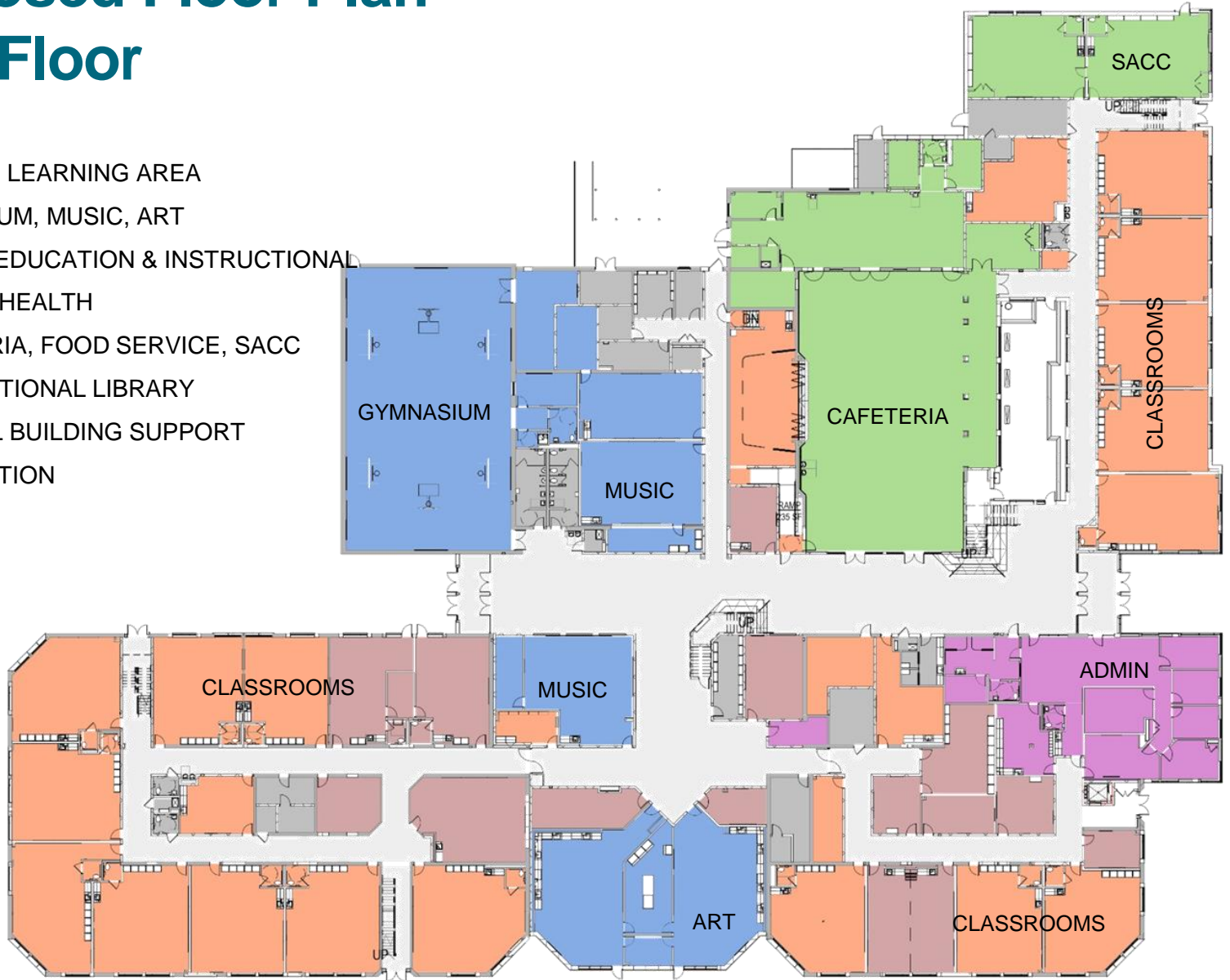

# Proposed Floor Plan

## Second Floor

### LEGEND

- GENERAL LEARNING AREA
- GYMNASIUM, MUSIC, ART
- SPECIAL EDUCATION & INSTRUCTIONAL
- ADMIN & HEALTH
- CAFETERIA, FOOD SERVICE, SACC
- INSTRUCTIONAL LIBRARY
- OVERALL BUILDING SUPPORT
- CIRCULATION

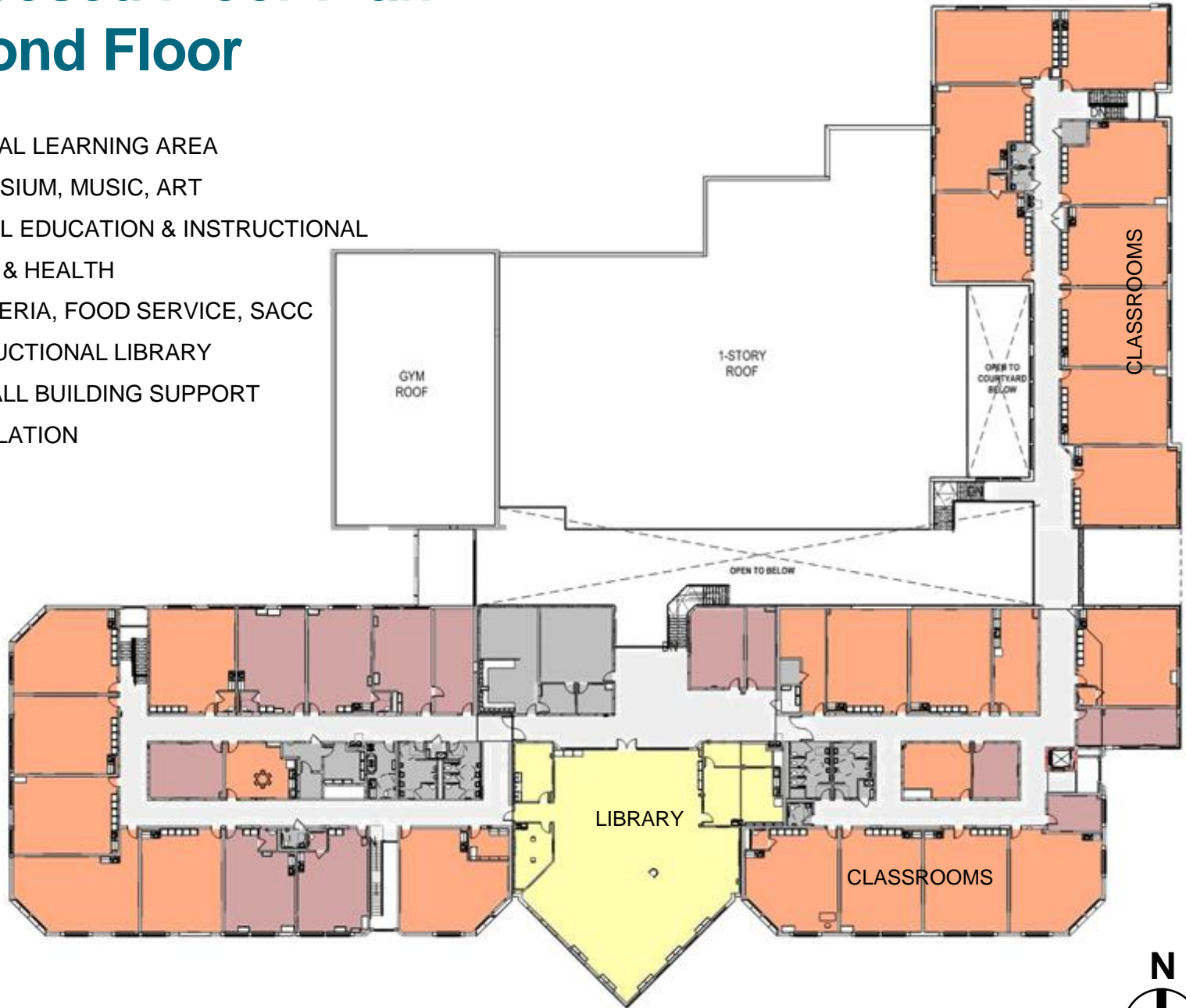

# Exterior Views



Aerial View



# Exterior Views



Main Entrance and Bus Parking

# Exterior Views



Admin Addition and Bus Loop



# Exterior Views



Library Addition and Kiss & Ride



# Interior Views



Main Lobby

# Interior Views



Main Lobby and Cafeteria Entrance



# Interior Views



Lobby View from Bridge



# Interior Views



Main Lobby and Library Entrance

# Interior Views



Library

# Interior Views



Cafeteria



# Interior Views



Courtyard

# Interior Views



Gymnasium

# Thank you!

FOR MORE INFORMATION, GO TO [WWW.FCPS.EDU](http://WWW.FCPS.EDU) AND SEARCH FOR  
DRANESVILLE ELEMENTARY

OR

<https://www.fcps.edu/dranesville-elementary-capital-project>

FOR COMMUNITY USE INFORMATION DURING RENOVATION,  
PLEASE EMAIL:

[FCPSCommunityUse@fcps.edu](mailto:FCPSCommunityUse@fcps.edu)



[www.fcps.edu](http://www.fcps.edu)